

Parts List

[x]	Part #	Sub-Assembly	Description	Copies	# Cut	Thick	Width	Length	Material Type	Material Name	Banding	<Info>	Diagram #s
[]	1	CNC Cabinet Base	Plywood Bottom Panel	1	0	3/4"	26"	50"	Sheet Good	Maple plywood	None		C2
[]	2	CNC Cabinet Base	Plywood Divider	1	0	3/4"	25 1/2"	32 1/4"	Sheet Good	Maple plywood	None		C2
[]	3	CNC Cabinet Base	Plywood Sides	2	0	3/4"	26"	33"	Sheet Good	Maple plywood	None		C1, C3
[]	4	CNC Cabinet Base	Plywood Top	1	0	3/4"	28"	53 1/2"	Sheet Good	Maple plywood	None		C3
[]	5	CNC Cabinet Base	Plywood Top Stretchers	1	0	3/4"	6"	50 3/4"	Sheet Good	Maple plywood	None		C2
[]	6	CNC Cabinet Base	Plywood Top Stretchers	1	0	3/4"	6"	50 3/4"	Sheet Good	Maple plywood	None		C2
[]	7	CNC Cabinet Base	Plywood Back Panel	1	0	1/2"	32 1/4"	50 3/4"	Sheet Good	Maple plywood	None		B1
[]	8	CNC Cabinet Base	Drawer Box - Front/Back	8	0	3/4"	6"	23 5/8"	Sheet Good	Maple plywood	None		C1
[]	9	CNC Cabinet Base	Drawer Box - Sides	8	0	3/4"	6"	23"	Sheet Good	Maple plywood	None		C1, C2, C3
[]	10	CNC Cabinet Base	Drawer Bottoms	4	0	1/4"	22 5/8"	23 1/2"	Sheet Good	Maple plywood	None		A1
[]	11	CNC Cabinet Base	False Drawer Front	4	0	3/4"	8 1/16"	25 3/4"	Sheet Good	Maple plywood	None		C3
[]	12	CNC Cabinet Base	Door	1	0	3/4"	25 3/4"	32 5/8"	Sheet Good	Maple plywood	None		C1

CNC Cabinet

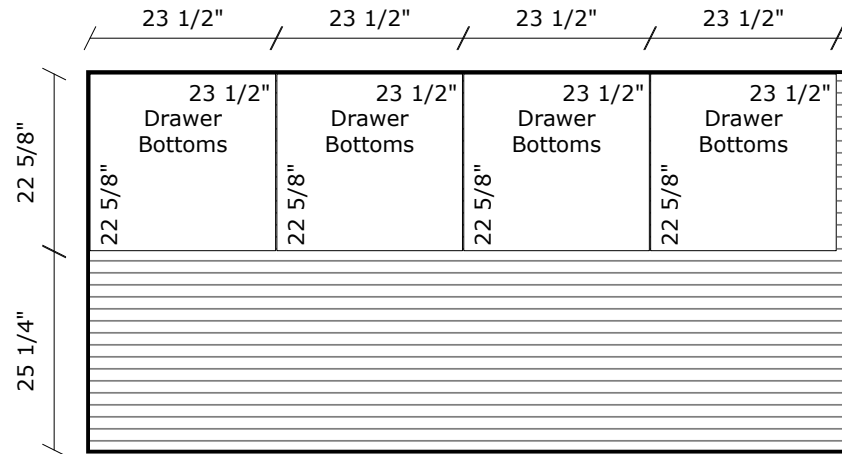

[A1] Maple plywood: 1/4" x 48" x 96"

Vendor: Bin:

[] 1 of 1 this size Qty this diag.: 1 Grain: Horizontal Stock Trim: 0"::0" Standard Layout

Kerf: 1/8" Part Padding: 0" Waste: 53.8% Final Cut Dimensions

Part #	Sub-Assembly	Description	Copies in Layout	Thick	Final Cut Y	Final Cut X	Rough Y	Rough X	Banding	<Info>
10	CNC Cabinet Base	Drawer Bottoms	4	1/4"	22 5/8"	23 1/2"	22 5/8"	23 1/2"	None	

CNC Cabinet

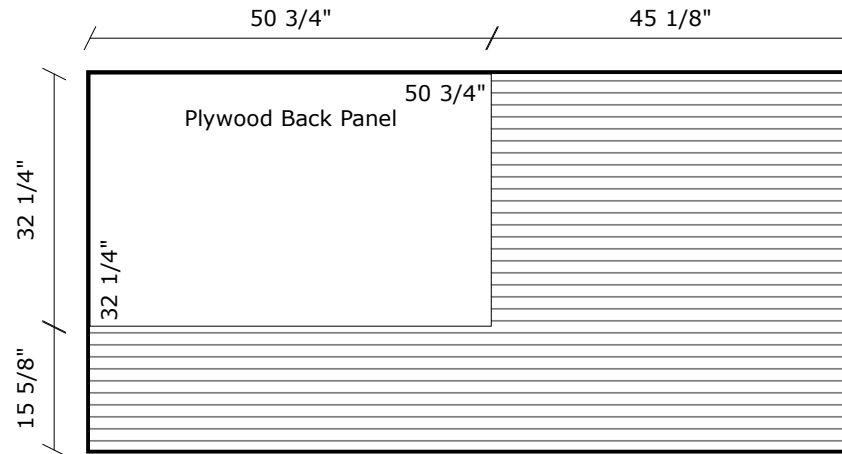

[B1] Maple plywood: 1/2" x 48" x 96"

Vendor: Bin:

[] 1 of 1 this size	Qty this diag.: 1	Grain: Horizontal	Stock Trim: 0"::0"	Standard Layout
Kerf: 1/8"	Part Padding: 0"	Waste: 64.5%	Final Cut Dimensions	

Part #	Sub-Assembly	Description	Copies in Layout	Thick	Final Cut Y	Final Cut X	Rough Y	Rough X	Banding	<Info>
7	CNC Cabinet Base	Plywood Back Panel	1	1/2"	32 1/4"	50 3/4"	32 1/4"	50 3/4"	None	

CNC Cabinet

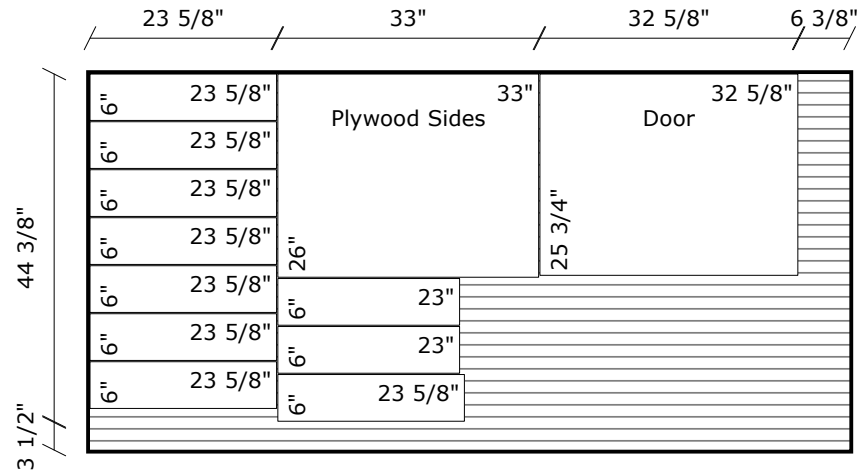

[C1] Maple plywood: 3/4" x 48" x 96"

Vendor: Bin:

[] 1 of 3 this size				Qty this diag.: 1	Grain: Horizontal	Stock Trim: 0"::0"	Manual Edit
Kerf: 1/8"	Part Padding: 0"	Waste: 32.6%	Final Cut Dimensions				

Part #	Sub-Assembly	Description	Copies in Layout	Thick	Final Cut Y	Final Cut X	Rough Y	Rough X	Banding	<Info>
3	CNC Cabinet Base	Plywood Sides	1	3/4"	26"	33"	26"	33"	None	
8	CNC Cabinet Base	Drawer Box - Front/Back	8	3/4"	6"	23 5/8"	6"	23 5/8"	None	
9	CNC Cabinet Base	Drawer Box - Sides	2	3/4"	6"	23"	6"	23"	None	
12	CNC Cabinet Base	Door	1	3/4"	25 3/4"	32 5/8"	25 3/4"	32 5/8"	None	

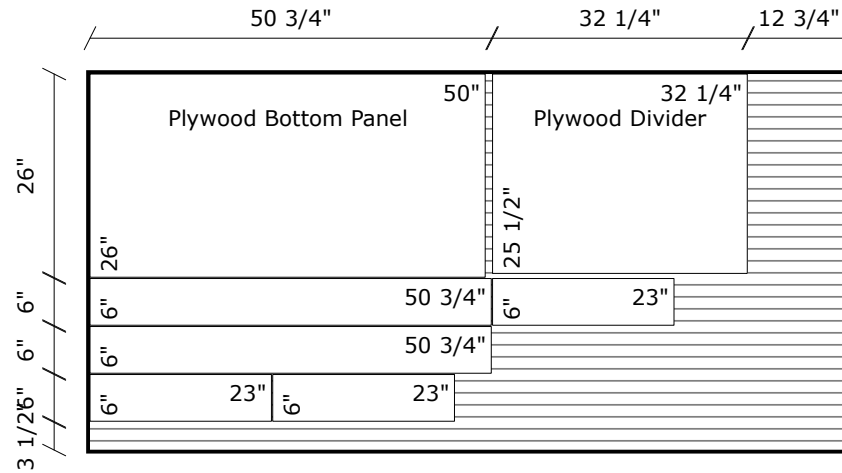

[C2] Maple plywood: 3/4" x 48" x 96"

Vendor: Bin:

[] 2 of 3 this size		Qty this diag.: 1	Grain: Horizontal	Stock Trim: 0"::0"	Manual Edit
Kerf: 1/8"	Part Padding: 0"	Waste: 31.7%		Final Cut Dimensions	

Part #	Sub-Assembly	Description	Copies in Layout	Thick	Final Cut Y	Final Cut X	Rough Y	Rough X	Banding	<Info>
1	CNC Cabinet Base	Plywood Bottom Panel	1	3/4"	26"	50"	26"	50"	None	
2	CNC Cabinet Base	Plywood Divider	1	3/4"	25 1/2"	32 1/4"	25 1/2"	32 1/4"	None	
5	CNC Cabinet Base	Plywood Top Stretchers	1	3/4"	6"	50 3/4"	6"	50 3/4"	None	
6	CNC Cabinet Base	Plywood Top Stretchers	1	3/4"	6"	50 3/4"	6"	50 3/4"	None	
9	CNC Cabinet Base	Drawer Box - Sides	3	3/4"	6"	23"	6"	23"	None	

CNC Cabinet

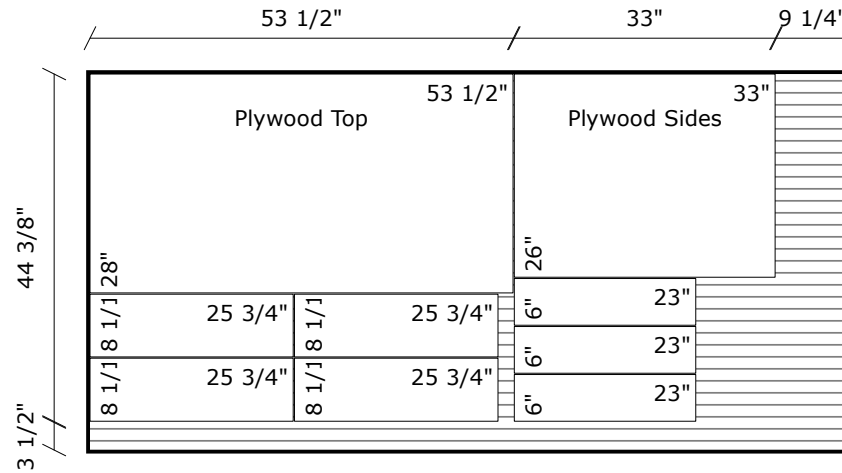

[C3] Maple plywood: 3/4" x 48" x 96"

Vendor: Bin:

[] 3 of 3 this size	Qty this diag.: 1	Grain: Horizontal	Stock Trim: 0"::0"	Manual Edit
Kerf: 1/8"	Part Padding: 0"	Waste: 21.9%	Final Cut Dimensions	

Part #	Sub-Assembly	Description	Copies in Layout	Thick	Final Cut Y	Final Cut X	Rough Y	Rough X	Banding	<Info>
3	CNC Cabinet Base	Plywood Sides	1	3/4"	26"	33"	26"	33"	None	
4	CNC Cabinet Base	Plywood Top	1	3/4"	28"	53 1/2"	28"	53 1/2"	None	
9	CNC Cabinet Base	Drawer Box - Sides	3	3/4"	6"	23"	6"	23"	None	
11	CNC Cabinet Base	False Drawer Front	4	3/4"	8 1/16"	25 3/4"	8 1/16"	25 3/4"	None	